

DESIGNED BY: J. J. Tippelt
 CHECKED BY: R. D. Hodge
 DRAWN BY: H. J. Hodge
 APPROVED BY: B. A. Lewis

ELEVATION
 1/4" = 1'-0"

SECTION B-B
 1/4" = 1'-0"

SECTION A-A
 1/4" = 1'-0"

SECTION C-C
 1/4" = 1'-0"

SECTION D-D
 1/4" = 1'-0"

SECTION C-C
 1/4" = 1'-0"

Note:
 For Footing Details see
 Sp. AR-3

Note:
 Formwork & surface
 finish for Pier Shaft
 above this level to be
 in accordance with
 requirements for
 Exposed Surfaces.

Note:
 Drain Pipe, Pier 5 only
 For details see Sp. AR-5

Note:
 Concrete for footings & shafts
 Piers 3 & 4 fc 3000 psi;
 Piers 5 & 6 fc 4000 psi.

AS BUILT

REV	DESCRIPTION	DATE
2	Rev location of reinforcement	3/28/44
1	Revision Pier Elevations	3/24/44
1	Checkers Corrections	3/24/44

SOUTHERN PACIFIC COMPANY
 CITY OF SAN BERNARDINO
 ARROW ROUTE-RIALTO AVE UNDERPASS
 BRIDGE M.P. 4900
 PIERS 3, 4, 5 AND 6
 DELEUW, CATHERS & COMPANY
 SAN FRANCISCO, CALIFORNIA
 SHEET NO. AR-7
 SCALE: 1/4" = 1'-0" & 1/8" = 1'-0"
 DATE: December 1963

COLTON CUT-OFF

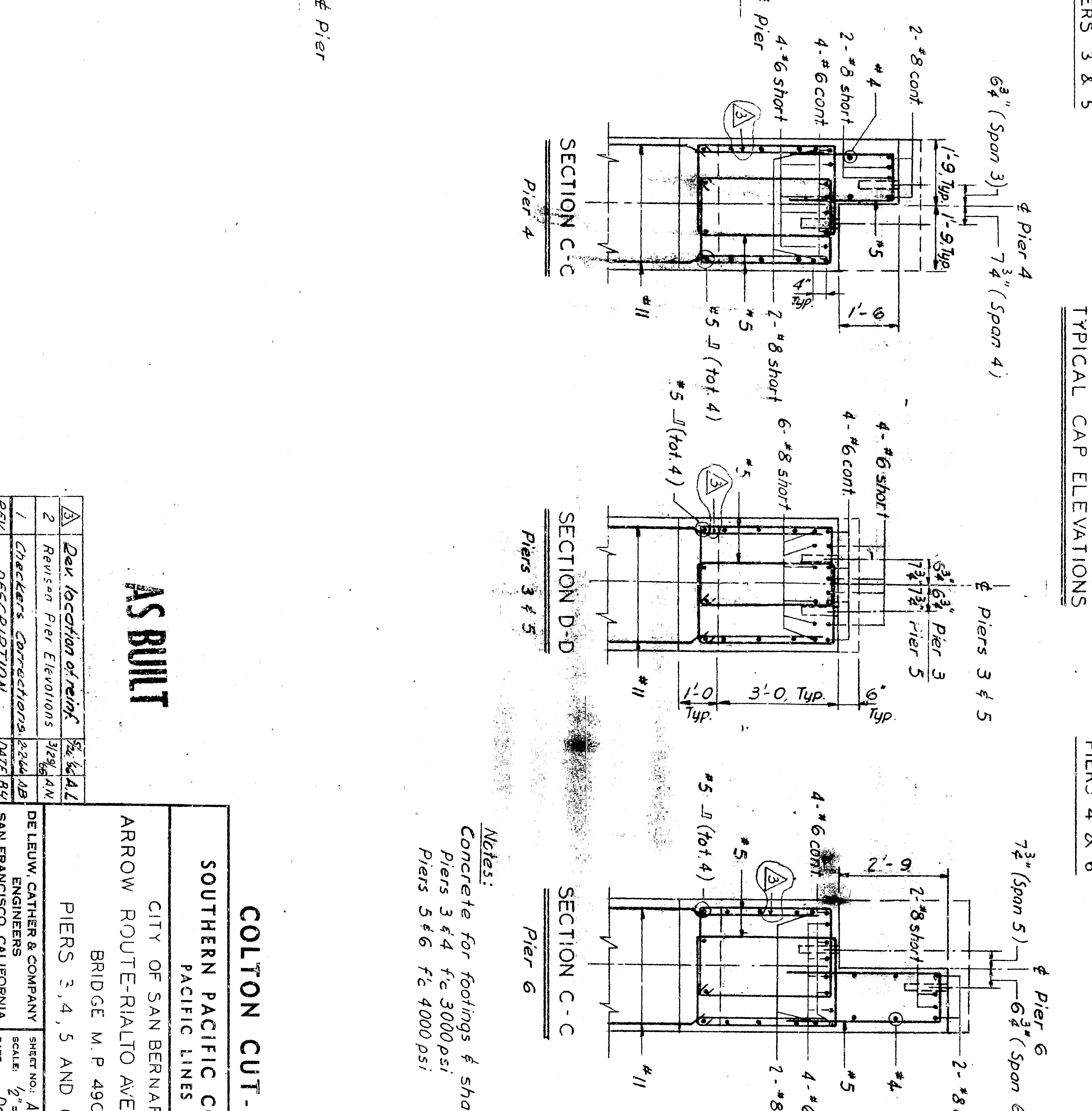
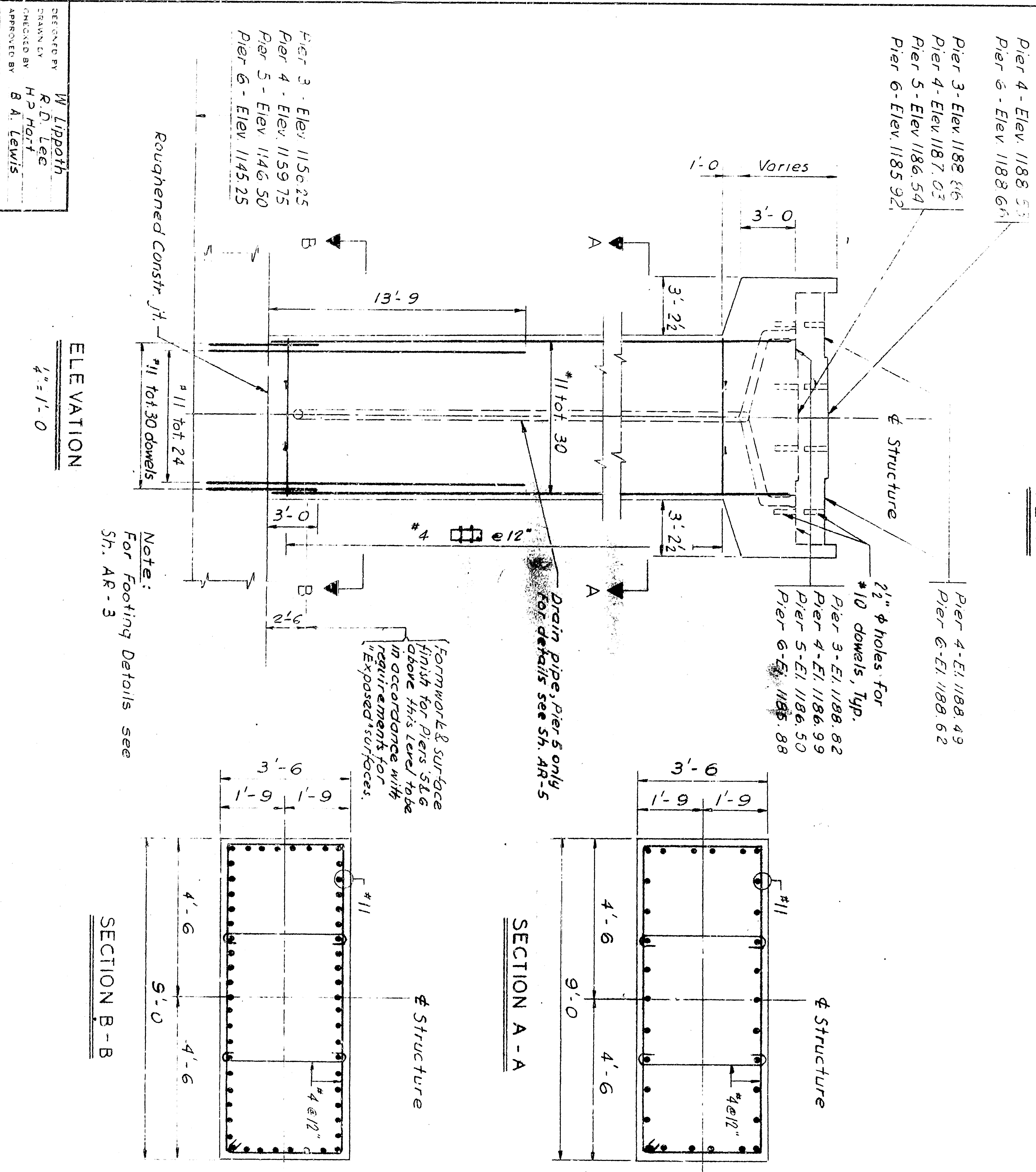
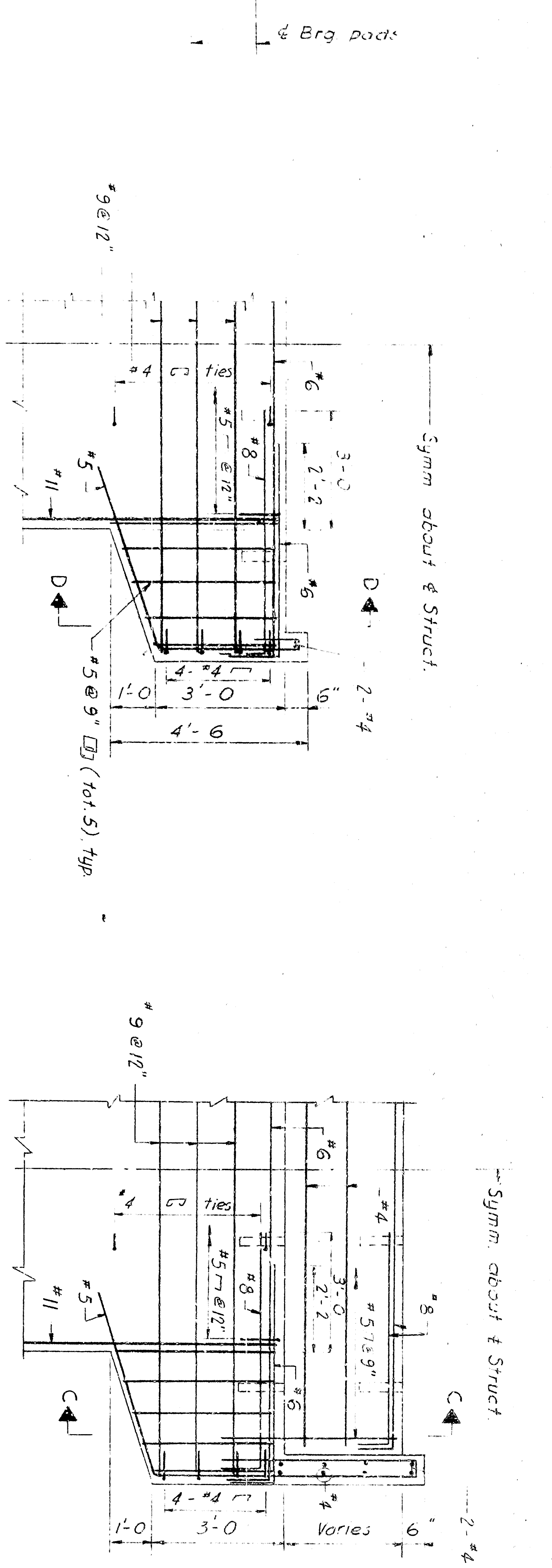
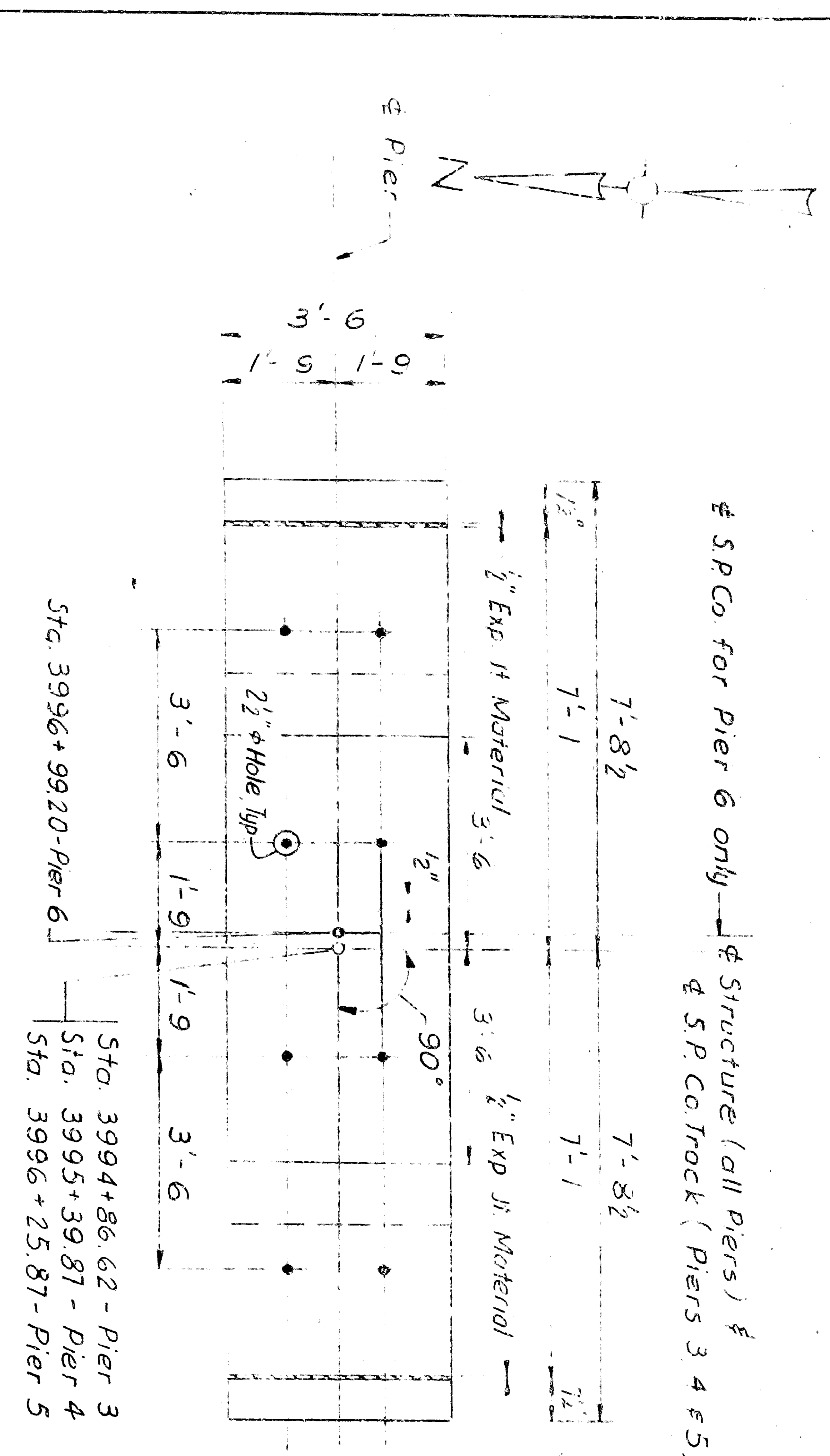

Notes:
 Concrete for footings & shafts
 Piers 3 & 4 fc 3000 psi;
 Piers 5 & 6 fc 4000 psi;

DESIGNED BY: R. D. MOSE
 CHECKED BY: H. J. MOSE
 APPROVED BY: B. A. LEWIS

ELEVATION
 1/4" = 1'-0"

SECTION B-B
 1/4" = 1'-0"

SECTION A-A
 1/4" = 1'-0"

SECTION C-C
 1/4" = 1'-0"

SECTION C-C
 1/4" = 1'-0"

SECTION C-C-C
 1/4" = 1'-0"

AS BUILT

SOUTHERN PACIFIC COMPANY

CITY OF SAN BERNARDINO

ARROW ROUTE-RIALTO AVE UNDERPASS

PIERS 3, 4, 5 AND 6

DELEW, CATHERS & COMPANY

ENGINEERS

DATE: December 1965

SHEET NO.: AR-7

SCALE: 1/4" = 1'-0" & 1/8" = 1'-0"

PROJECT NO.: 444

REVISION: Pier Elevations

DESCRIPTION: Checkers Corrections

DATE: 12/27/65